

DESTINATION

Tow bar **N-066** is designed for towing a trailer. This ball hook has a current certification of approval authorizing the product with **E20** certification sign.

FITTING CONDITIONS

Tow bar **N-066** can be used and operated in a car with proper technical conditions of body elements. Those parts cannot be mechanically damaged. The ball hook has to be installed and operated in a car according to this instruction. All bolts and nuts in ball hook have to be screwed down with proper torque (Mo). Torque values are given below:

M8	-	25 (Nm)	M12	-	85 (Nm)
M10	-	50 (Nm)	M16	-	200 (Nm)

OPERATION CONDITIONS

The tow bar **N-066** has a rating plate describing correct and safe loads of the hook:

Typ: N-066	Tow bar catalogue number.
A50-X	Tow bar class (compressing device)
E20 55R-01 3612	Tow bar certification of approval number
D = 6,9 kN	Teoretical related force working on a ball hook
S = 50 kg	Max permissible vertical load of the hook ball
R = 1200 kg	Max permissible load of towing trailer

D - force is calculated using the following formula:

$$D = g \times \frac{T \times R}{T + R} \text{ kN}$$

T-technically permissible maximum mass in tonnes of the towing vehicle (also towing tractors) including, if necessary, the vertical load of a centrale axle trailer.

R-technically permissible maximum mass in tonnes of the full trailer with drawgal free to move in the vertical plane or of the semi-trailer.

g-acceleration due to gravity (assumed as 9,81 m/s²)

During operating individual elements of ball hook should be kept in a proper technical condition and protected from corrosion. The trailer must be linked with an elastic joint with proper durability (cord, chain) while towing. It is necessary to check periodically bolt joints during operating the ball hook. If screws are eased, it is necessary to screw them down.

FITTING

The tow bar **N-066** is made up of the following elements:

1. Towbar mainframe	- 1 piece	8. Screw M10x25	- 4 pieces
2. Tow ball (ACS-2030)	- 1 piece	9. Screw M10x45	- 4 pieces
3. Tow ball socket (ACS)	- 1 piece	10. Screw M12x25	- 4 pieces
4. Right support	- 1 piece	11. Spring washer Ø10,2	- 8 pieces
5. Left support	- 1 piece	12. Spring washer Ø12,2	- 4 pieces
6. Electrical socket plate	- 1 piece	13. Flat washer Ø13,0	- 4 pieces
7. Special washer Ø30/Ø10,5x3	- 8 pieces		

Please follow the installation fitting instruction below in order to ensure correct installation of the towbar:

1. Rear bumper removing and cutting is required
2. Remove the rear bumper and remove the supports from on the right and left side of the rear belt (supportswill not be re-used).

3. Lower the silencer with hanger
4. Put the supports (4, 5) in the stringers and screw on in points A using bolts M10x25 (8) with spring washers Ø10,2 (11) and Ø30/Ø10,5x3 (7).
5. Into the stringers slide the towbar mainframe (1) and screw on in points B using bolts M10x45 (9) with spring washers Ø10,2 (11), washers Ø30/Ø10,5x3 (7) (Make cutout in the plastic bumper cover at the point of contact with the ball handles approximately 85mm in width and 15mm deep approx).
6. Tighten all screws.
7. Hang on the silencer
8. Make an undercut in the bumper according to the fig. 1.
9. Install the bumper.
10. Tighten the stow ball socket (3) and electrical plate (6) to the towbar mainframe (1) using bolts M12x25 (10) with spring washers Ø12,2 (12), round washers Ø13,0 (13).
11. Put ball (2) to the socket (3) in accordance with attached instruction.

Caution:

Different types of (2) may be attached to the (1) only if:

1. The adapted tow has its own information label with homologation number
2. D and S values are equal or higher than (1) values.
3. Tow ball centre-point is in accordance with the drawing

Obeying this instruction assures correct montage and the N-066 tow bar operating.

After assembling of the tow bar **N-066** you have to get entry in cars **registration book**.

CAUTION:

Check if all bolts and nuts are correctly tightened after 1000km. Keep tow ball clean, grease and cased. All mechanical damages of tow bar excludes its further exploitation. Damaged ball hook **cannot be repaired**. In case of braking the rules of montage or unproper usage manufacturer **do not take responsibility** for arised damages.

MONTAGE DIAGRAM:

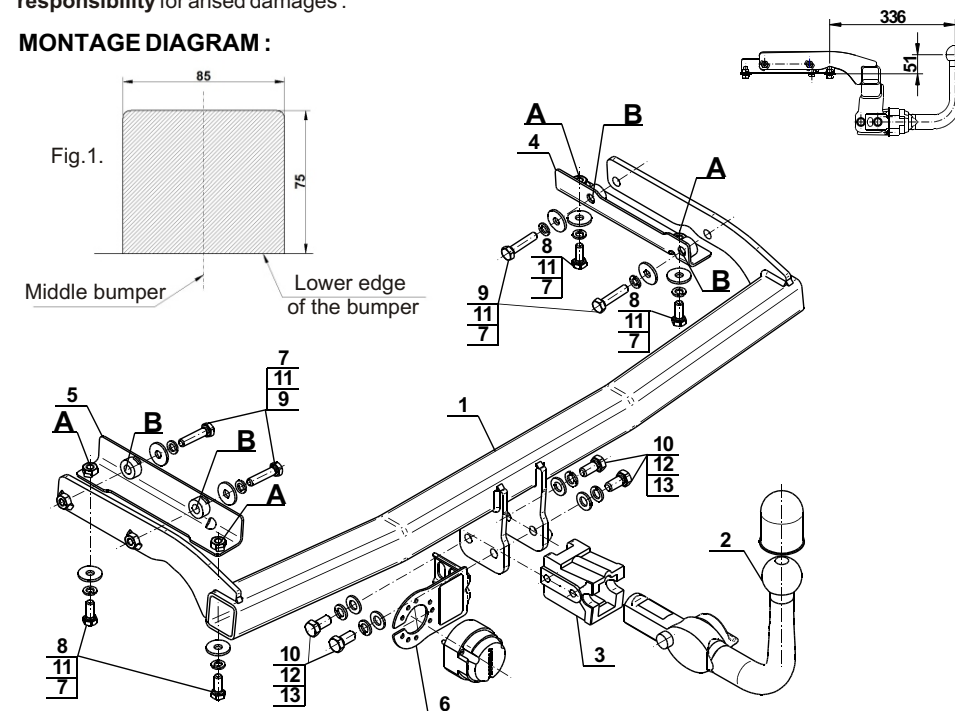

NOTE:

Bunch of wires is not included (in total price).